



# Greville Avenue

Spinney Hill, Northampton

oriordanbond  
SALES & LETTINGS





GROUND FLOOR  
508 sq.ft. (47.2 sq.m.) approx.

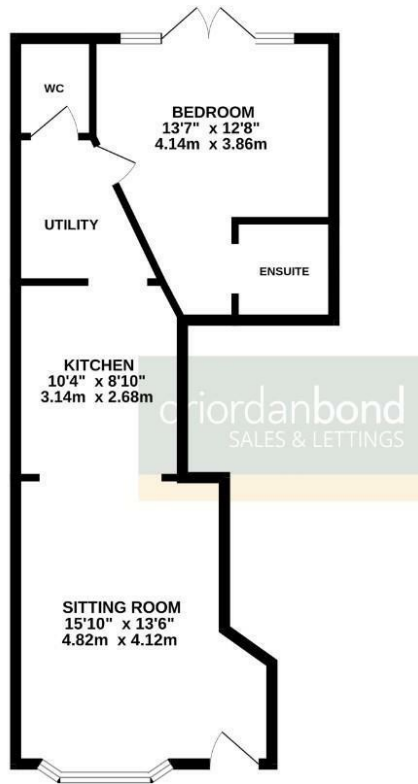

TOTAL FLOOR AREA: 508 sq.ft. (47.2 sq.m.) approx.  
Whilst every attempt has been made to ensure the accuracy of the floorplan contained here, measurements of doors, windows, rooms and any other items are approximate and no responsibility is taken for any error, omission or misstatement. This plan is for illustrative purposes only and should be used as such by any prospective purchaser. The services, systems and appliances shown have not been tested and no guarantee as to their operability or efficiency can be given.  
Made with NetScout C5025

## Greville Avenue

Spinney Hill  
NN3 6BY

GUIDE PRICE £130,000

A rarely available Freehold ground floor one double bedroom maisonette, situated in Spinney Hill, close to lots of amenities and good transport links. The property is offered for sale with no onward chain.

Accommodation comprises entrance, spacious sitting/dining/kitchen, utility, separate WC and large double bedroom with en-suite shower. Outside is a private rear courtyard garden with access to a double garage and two allocated parking spaces to the front. Benefits include uPVC double glazing, electric heating and air conditioning unit. (B/508/S)

### Additional information

- Council Tax Band: A
- Energy Efficiency Rating: F

### Viewing

Viewing strictly by appointment – details below

### Disclaimer

O'Riordan Bond Estate Agents Limited has not tested apparatus, equipment, fittings or services and so cannot verify they are in working order. The buyer is advised to obtain verification from their solicitor or surveyor.

O'Riordan Bond Parklands Sales  
01604 639007

[parklands@oriordanbond.co.uk](mailto:parklands@oriordanbond.co.uk)

